

BOROUGH OF EDGEWORTH

301 Beaver Road
Edgeworth, PA 15143

Office of the
Borough Manager

412-741-2866
Fax 412-741-6998

The attached Plumbing Abstract Form should be returned to the Borough of Edgeworth Office and not to Allegheny County. Mr. Frederick Gregorich, Building Code Official, does the plumbing inspections for Edgeworth.

There is no additional cost for this form, as it is included in the cost of the approved Building Permit or Zoning Permit. Please feel free to call the above phone number with any questions you may have.

Thank you.

Treasurer's Receipt No.

WARD OR MUNICIPALITY PLAN

Filed Approved by

No.	FIXTURES	Amount
	PLAN FEE	
	AREA DRAIN	
	AUTOMATIC WASHER (Stand.Pipe)	
	BATH TUB	
	BUILDING SEWER	
	DISHWASHER (Built In)	
	DRINKING FOUNTAIN	
	FLOOR DRAIN	
	HOUSE TRAP	
	LAUNDRY TRAY	
	LAVATORY (Wash Basin)	
	MASTER BACK FLOW PREVENTER	
	RAIN CONDUCTOR	
	SAFE WASTE	
	SERVICE SINK	
	SHOWER	
	SINK	
	SITE WORK-SANITARY (Additional Footage)	
	SITE WORK-STORM (Additional Footage)	
	SITE WORKWATER (Additional Footage)	
	URINAL	
	WATER CLOSET	
	WATER HEATER	
	WATER SERVICE AND DISTRIBUTION	
	MISCELLANEOUS	
	MODULE	
	RECIPROCAL	
	TOTAL FIXTURES	
	TOTAL RECEIPT	

PLANS FOR SEWER CONNECTIONS MUST BE APPROVED BY AP-
PROPRIATE MUNICIPALITY BEFORE SUBMISSION
TO THE PLUMBING DIVISION

SEWER	CERTIFICATE NO.	APPROVED BY	SIZE	DATE
COMBINED				
SANITARY				
STORM				

New Existing

BUILDINGS TO BE OCCUPIED AS _____

LOCATION _____

Between _____

and _____

OWNER _____

ADDRESS _____

Zip Code

PLUMBER (PRINT) _____ Phone _____

ADDRESS _____

Zip Code

Reciprocal Registration Fee _____ H.P. NO. _____

(License Number)

RECIPROCAL MASTER: _____

LICENSED OUT OF: _____

RECIPROCAL JOURNEYMAN: _____

SIGNATURE: _____

**SOLDERS AND
FLUXES FOR POTABLE
WATER SYSTEMS
SHALL BE LEAD FREE**

**Final Inspection
Required**

ELEVATION PLAN

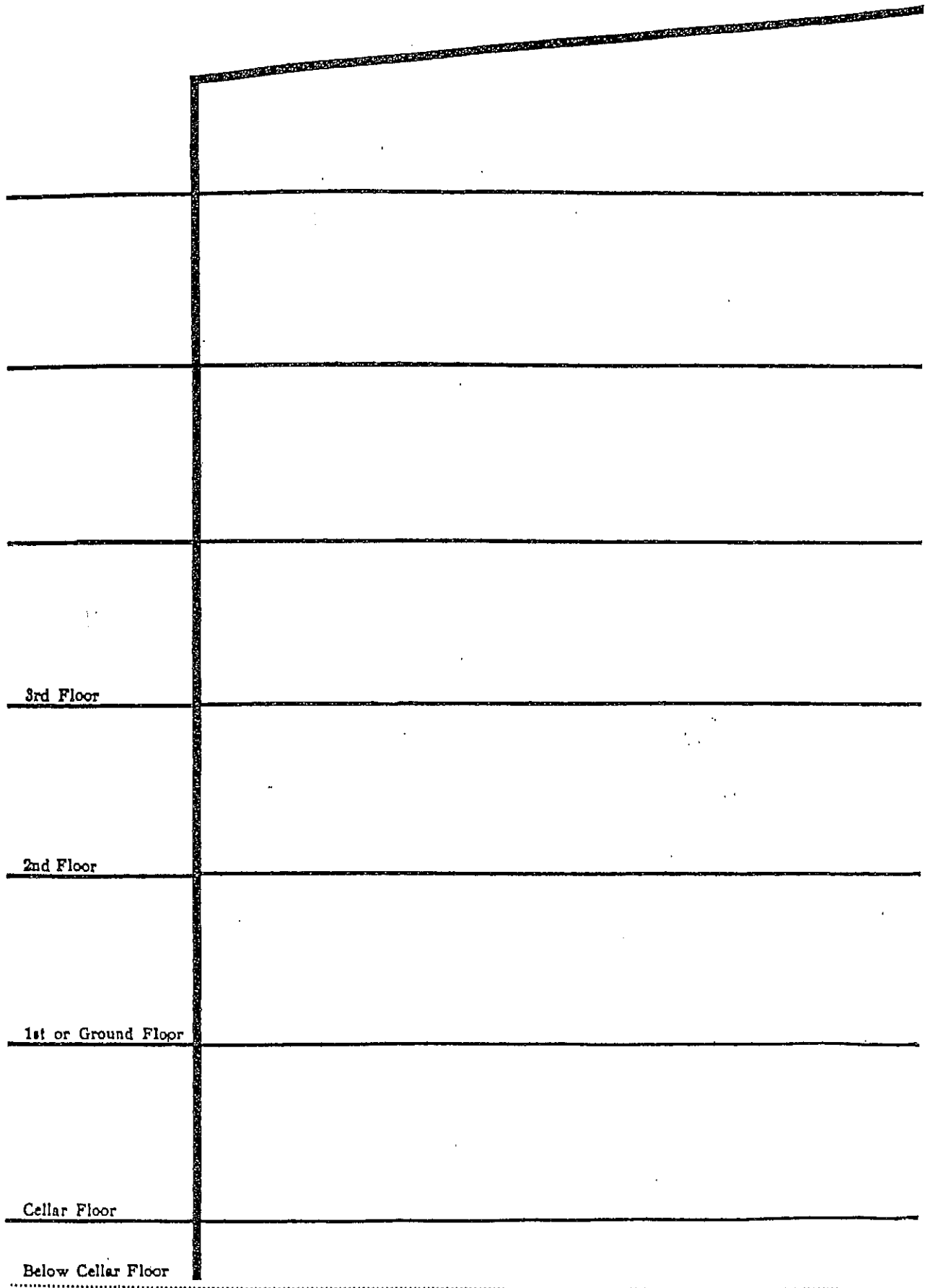

MARK SOIL, WASTE AND VENT PIPE SIZES AND MATERIALS; ALSO TRAP SIZES.

MARK BUILDING DRAIN SIZE AND MATERIAL.

LOT PLAN

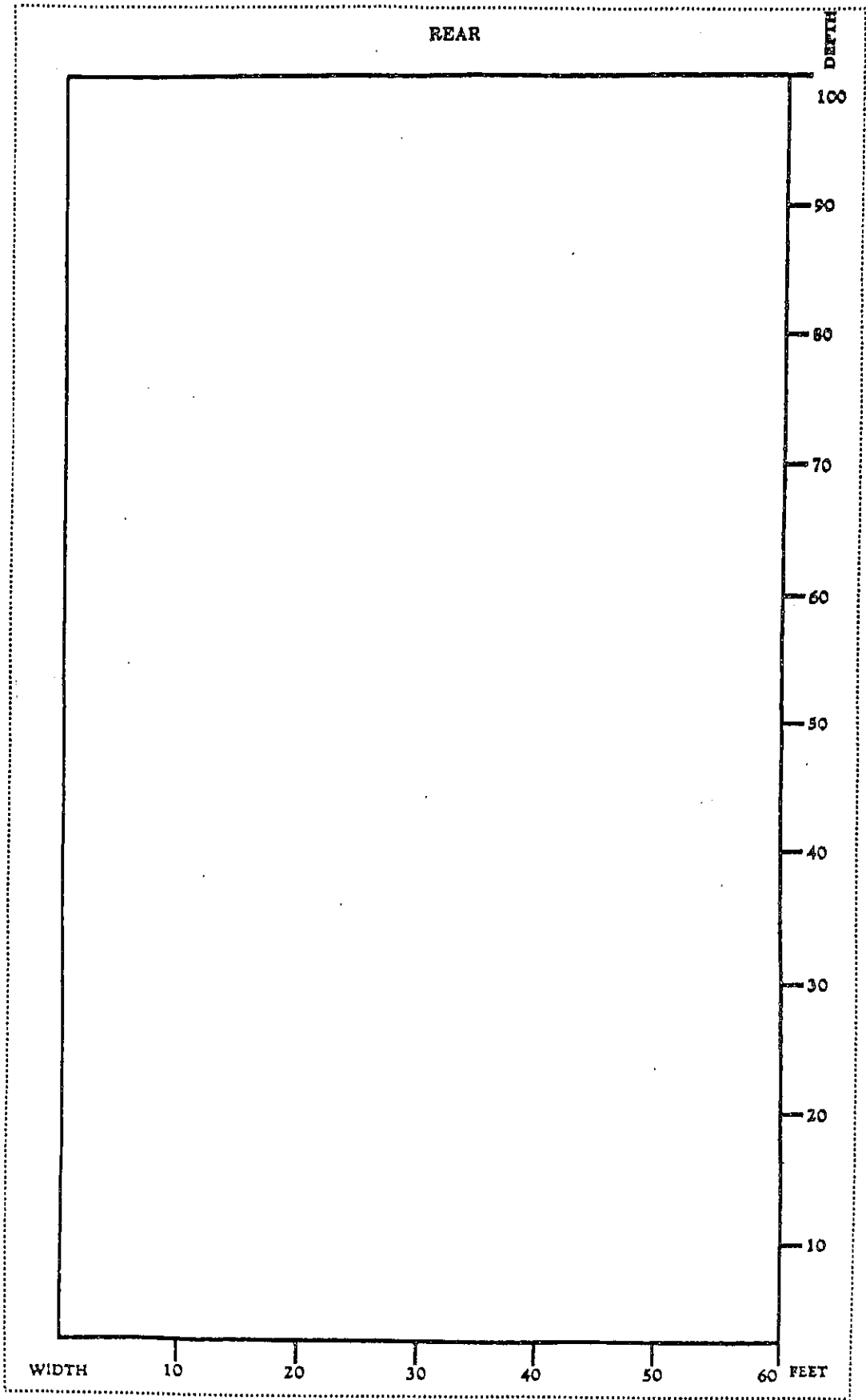

————— INDICATES PROPERTY LINE
..... INDICATES CURB LINE

MARK BUILDING DRAIN SIZE AND MATERIAL.

**ABSTRACT OF SPECIFICATIONS
FOR
PLUMBING OR HOUSE OR BUILDING DRAINAGE**

Date: _____

TO THE BOROUGH OF EDGEWORTH,
BUILDING CODE DEPARTMENT

The following Abstract of Specifications for Plumbing or House or Building Drainage, with Description and accompanying Plan, are submitted for approval:

DESCRIPTION OF PLAN AND ABSTRACT OF SPECIFICATIONS

All work, material and construction to be in accordance with the rules and regulations relating to the 2009 Editions of the International Building Code and the International Plumbing Code as well as all referenced materials, and to comply therewith in all particulars, whether specified or not.

All drains from roofs, yards, ramps, areas and courts must be drained according to the Edgeworth application regulations.

Section 1301. Total sq. ft. _____

This complaint no. _____ will be corrected in _____ days.

Has a previous plan for this work been filed or approved by this office? _____

Openings in grill of fresh air inlet must equal the area of inlet pipe.

Access Door Provided? _____ Yes _____ No

Signature

MARK ALL NEW WORK IN OLD BUILDINGS IN RED INK.

REMARKS

